

## ▶ Application

HZ10 series combination switch is applicable for circuit of AC50Hz, rated operational voltage 380V and below, DC voltage 220V and below, and manual connect and break circuit unfrequently. And it also can control low-capacity AC motor directly, circuit measuring and circuit transfer. This production conforms to standard of GB14048.3-2008 and IEC60947-3.

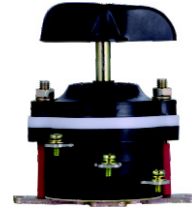

## ▶ Structure

The fixed contacts and the moving contacts are installed in the insulation parts. And the moving contacts follows the handle to rotate and change the connecting and making position. The operating mechanism consists of the slide piece, cam, torsion spring and handle. The operating mechanism stores energy by torsional spring, energy storage has no relation with handle operation speed to improve the production performance.

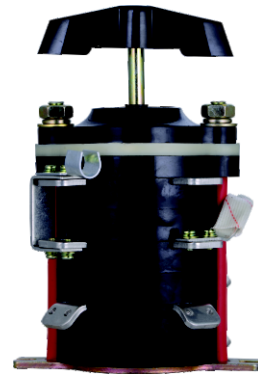

## ▶ Model No.

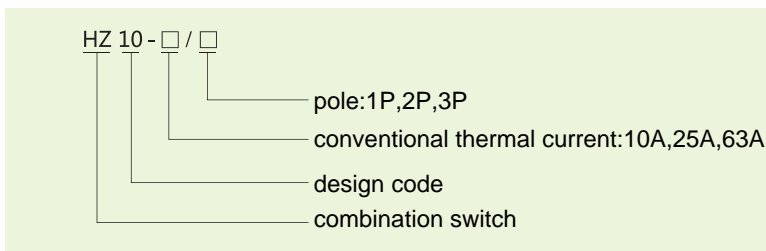

## ▶ Main Technical data

- 4.1 rated operation voltage
  - a: AC380V
  - b: DC220V
- 4.2 rated insulation voltage: 660V
- 4.3 conventional thermal current: 10A, 25A, 63A
- 4.4 Using type: AC-22A, DC-21A

## ▶ Normal working condition and installation condition

- 5.1 Altitude: lower than 2000m.
- 5.2 Ambient temperature: no higher than +40°C, and no lower than -5°C, and day average temperature shall no more than +35°C.
- 5.3 Humidity: Relative humidity shall not exceed 50% at the Max temperature, and higher humidity could be accepted at lower temperature. The condensation must be taken care which is caused by temperature change.
- 5.4 Pollution class: III type
- 5.5 Installation level: II, III type
- 5.6 Installation location: without obvious vibration, rain and snow affection, and no corrosion gas and dust.
- 5.7 Install in any declining plate.

## ▶ Motor direct control type parameter

Table1

Model No.	Limiting operating current at 380V				strat and control the Y series motor at 380V	
	closed		break		Capacity(kW)	current(A)
	current(A)	times	current(A)	times		
HZ10-10/3	94	100	62	10	3	7
HZ10-25/3	155	100	108	10	3.5	12

Note: motor reversing control switch,it only can start reverse after motor had been stopped.

## ▶ Appearance and mounting dimensions

Appearance dimension and mounting dimension see Fig1, Fig2, Table2

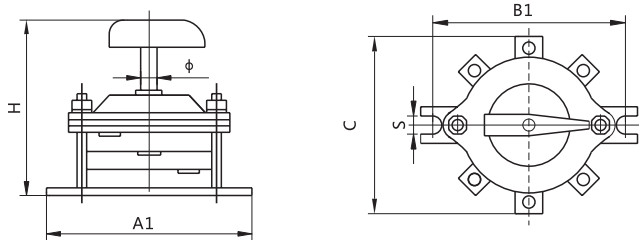

Fig1 Front-connection type

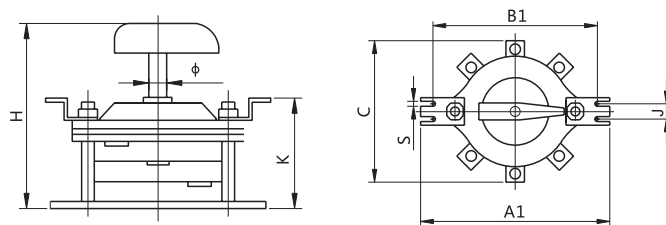

Fig2 Back-connection type

Table2

Model NO.	Appearance dimension				Installation dimension						Note
	A1	A2	H	C	Φ	B1	B2	S	J	K	
HZ10-10	65	86	6D+6n	50	6	55	74	5	-	29+6n	"n" for pole
HZ10-25	100	114	78+10n	92	8	90	100	6	-	38+6n	
HZ10-63	142	153	102+15n	132	9	128	139	7	13	47+6n	

▶ Connection diagram

Table3

Model No.	pole	section	connection diagram	conventional thermal current A		
				10	25	63
HZ10-□/1	1	1	1	√		
HZ10-□/2	2	2	2	√	√	√
HZ10-□/3	3	3	3	√	√	√

Table4

