

## ▶ Application

Foot switch is applicable for circuit of AC50-60Hz, rated operational voltage up to 380V, rated control capacity up to 300VA, conventional heating current up to 5A, as connecting and breaking circuit frequently.

This production conforms to standard of GB14048.5.



## ▶ Main technical parameter

2.1 Electrical life, see Table1:

Table1

current type	Rated operational voltageV	Connect and break				operation frequency /hour	total time (thousand)
		connecting currentA	cos φ ±0.05	breaking currentA	cos φ ±0.05		
AC	380	7.9	0.25	0.79	0.25	120	20

2.2 connecting and breaking operation times shall not less than 1million times. see Table2,

Table2

current type	Rated operational voltageV	Rated operation powerVA	Connect and break		power factor cosφ ± 0.05	charge times ms	intervals time s	times
			connect	break				
AC	380	300	1.1Ue×10Ie	1.1Ue×Ie 0.2		60-200	5-10	50

## ▶ Overall and mounting dimension

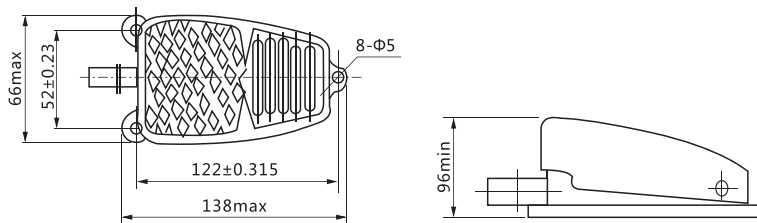

Fig1

## ▶ Installation and using

Switch has rubber lead wire, should connect to working circuit as following circuit.

